



## 9 Yalding Close, Frindsbury, ME2 3XF

Virtual Tour Available. A lovely starter home in popular Frindsbury, which has been recently refurbished and offered to the market with NO FORWARD CHAIN!! GARAGE EN-BLOC.

Upon entering you are greeted by a good size lounge/diner with lots of light and finished with neutral decor. Access to the first floor is offered via the staircase to the rear of the lounge. A new installed modern kitchen can be found at the back stretching the width of the property and leads on to the rear garden. The kitchen offers plenty of cupboards and work top space and has room for a fridge, freezer and cooker. To the first floor there are two double bedrooms and family bathroom. Added benefits include gas central heating, double glazed windows, a front and rear garden, a garage en-bloc and NO CHAIN!

Frindsbury today is part of the town of Strood and covers mostly the northern part. Frindsbury refers to both a parish and a manor. Within the civil parish of Frindsbury Extra are the villages of Frindsbury, Wainscott, and Upnor.

There are many amenities within close proximity including schools, shops, bus routes and easy access to the M2/A2 and the Medway Tunnel. Strood train station is within walking distance.

Don't delay in booking your appointment to view this end of terrace property  
COUNCIL TAX BAND C

- RECENTLY REFURBISHED
- NO CHAIN
- COUNCIL TAX BAND C
- GARAGE EN BLOC
- POPULAR LOCATION
- TWO DOUBLE BEDROOMS
- UPSTAIRS BATHROOM
- REAR GARDEN
- VIEWING ADVISED

**£265,000**



Ground Floor

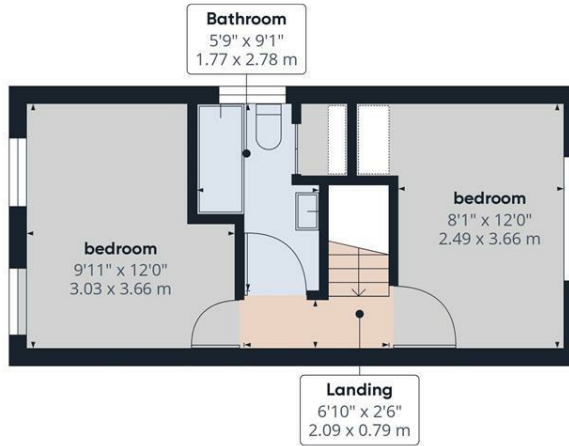

Floor 1

Approximate total area<sup>m</sup>  
584.45 ft<sup>2</sup>  
54.3 m<sup>2</sup>

Excluding balconies and terraces

While every attempt has been made to ensure accuracy, all measurements are approximate, not to scale. This floor plan is for illustrative purposes only.

GIRAFFE360

